

## sfiati e ombrinali vents and scuppers

### 1188D

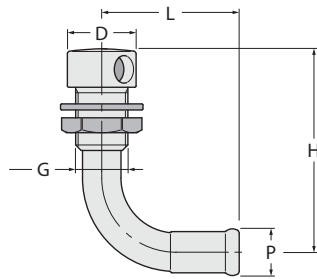

**Sfiato con portagomma curvo destro**  
90° gas tank vent with hose connection.  
right side



**Ottone cromato**  
Chromium-plated brass

<b>1188D</b>	■
<b>1188DL</b>	■
Weight (gr)	97
L	52
D	25
H	77
P	17
G	19x19F
<b>Size</b>	<b>ø19x16</b>

### 1188DL

**Ottone lucido**  
Polished brass

### 1188S

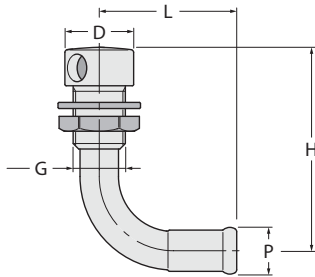

**Sfiato con portagomma curvo sinistro**  
90° gas tank vent with hose connection.  
left side



**Ottone cromato**  
Chromium-plated brass

<b>1188S</b>	■
<b>1188SL</b>	■
Weight (gr)	97
L	52
D	25
H	77
P	17
G	19x19F
<b>Size</b>	<b>ø19x16</b>

### 1188SL

**Ottone lucido**  
Polished brass

### 1190

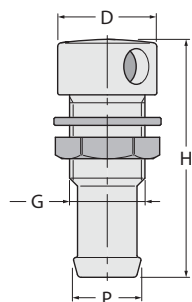

**Sfiato diritto**  
Straight gas tank vent



**Ottone cromato**  
Chromium-plated brass

FILETTATURE / THREAD :  
G = ISO 228/1 (BS 2779)

<b>1190</b>	■	■
<b>1190L</b>	■	■
Weight (gr)	85	205
H	60	70
D	25	32
P	16	20
G	19x19F	3/4"
<b>Size</b>	<b>ø19x16</b>	<b>3/4"x20</b>

### 1190L

**Ottone lucido**  
Polished brass



GENERAL  
*Marine*  
SERVICES

156 Beaumont Street · Westhaven · Auckland · New Zealand

Sales Ph +64 9 309 0048 · sales@generalmarine.co.nz

Service Ph +64 9 368 0938 · service@generalmarine.co.nz

[www.generalmarine.co.nz](http://www.generalmarine.co.nz)