

Tails- Long Thread 90°

Designed and made in New Zealand, TruDesign Long Thread Tails are the superior composite connection for fitting hose to threaded fittings.



TruDesign Tails are moulded from a glass reinforced nylon composite. High strength, high-modulus glass fibres impregnated into the nylon provides dramatic strength, stiffness, toughness, and dimensional stability. TruDesign Tails eliminate the corrosion and electrical bonding problems associated with metallic fittings. The Tails are designed for twin hose clamps, and to not crush under high load conditions.

MODELS

Part #	Description
90517	Tail 13mm ½" BSP Long Thread 90°
90565	Tail 13mm ½" BSP Long Thread 90° PKG
90372	Tail 19mm ¾" BSP Long Thread 90°
90566	Tail 19mm ¾" BSP Long Thread 90° PKG
90373	Tail 25mm 1" BSP Long Thread 90°
90567	Tail 25mm 1" BSP Long Thread 90° PKG
90374	Tail 32mm 1½" BSP Long Thread 90°
90568	Tail 32mm 1½" BSP Long Thread 90° PKG
90375	Tail 38mm 1½" BSP Long Thread 90°
90569	Tail 38mm 1½" BSP Long Thread 90° PKG
90376	Tail 50mm 2" BSP Long Thread 90°
90570	Tail 50mm 2" BSP Long Thread 90° PKG
90877	Tail Unequal 16mm ½" BSP Long Thread 90°
90878	Tail Unequal 16mm ½" BSP Long Thread 90° PKG
90529	Tail Unequal 38mm 1½" BSP Long Thread 90°
90571	Tail Unequal 38mm 1½" BSP Long Thread 90° PKG

PKG product is supplied in bags with header cards

LEADERS IN MARINE COMPOSITE FITTINGS

www.trudesignplastics.com



GENERAL
Marine
SERVICES

156 Beaumont Street · Westhaven · Auckland · New Zealand

Sales Ph +64 9 309 0048 · sales@generalmarine.co.nz

Service Ph +64 9 368 0938 · service@generalmarine.co.nz

www.generalmarine.co.nz

**PRODUCT
INFORMATION**

KEY FEATURES

Feature :	Benfit
Manufactured from a glass reinforced nylon composite	High strength and light weight.
Compatible with all hull types	Can be used on aluminum, steel, wood or FRP hulls.
Immune to corrosion and electrolysis	Long life with no concerns over decreased performance due to corrosion.
Chemical resistant	Impervious to diesel, petrol and antifouling paints.
UV resistant	These fittings will not break down with ultraviolet light or discolour from the sun.
High quality surface finish	Will not discolour with green film as similar bronze fittings do.
Fits Tru-Design Ball Valves & BSPP threads	Universal compatibility to other Tru-Design fittings, and other marine components.
Large operating temperature range	Suitable for all marine environments, from -40°C to +110°C.

SPECIFICATIONS

The connecting threads on the Tails are BSP (British Standard Pipe) and are parallel. These parallel threads are designed so that thread tape is wound onto the tail then screwed into place. The advantage of parallel threads rather than tapered is that there is maximum engagement between the mating threads providing a strong and watertight seal.

Mixing parallel and tapered threads can cause strength and sealing problems as the engagement can frequently be only a few turns.

FLOW DIAMETER & THREAD LENGTH

Tail Size	Thread Size	Minimum I.D.	Thread Length
13mm	½"	8mm	25mm
19mm	¾"	13mm	25mm
25mm	1"	19mm	30mm
32mm	1¼"	25mm	30mm
38mm	1½"	30mm	30mm
50mm	2"	42mm	30mm
38mm	1¼"	30mm	30mm

LEADERS IN MARINE COMPOSITE FITTINGS
www.trudesignplastics.com

**GENERAL
Marine
SERVICES**
156 Beaumont Street · Westhaven · Auckland · New Zealand
Sales Ph +64 9 309 0048 · sales@generalmarine.co.nz
Service Ph +64 9 368 0938 · service@generalmarine.co.nz
www.generalmarine.co.nz

DIMENSIONS

All dimensions in mm.
All dimensions nominal.

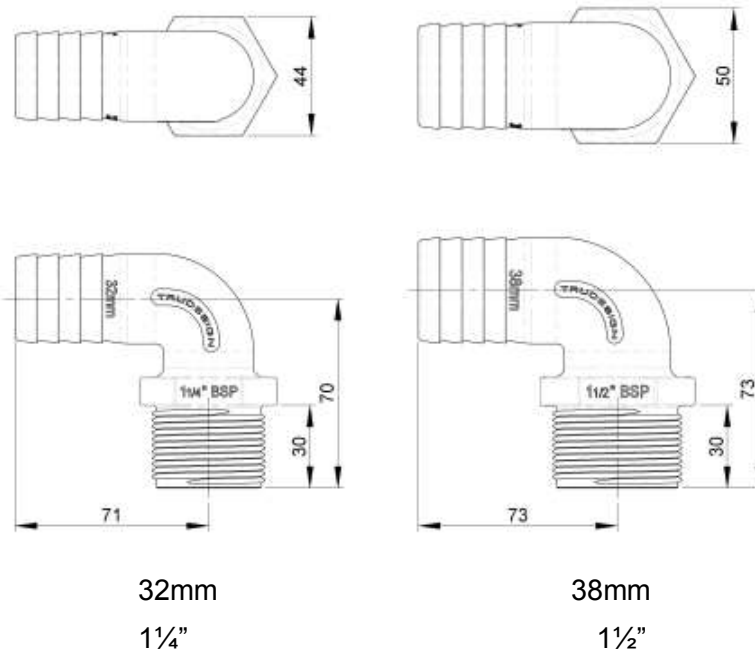
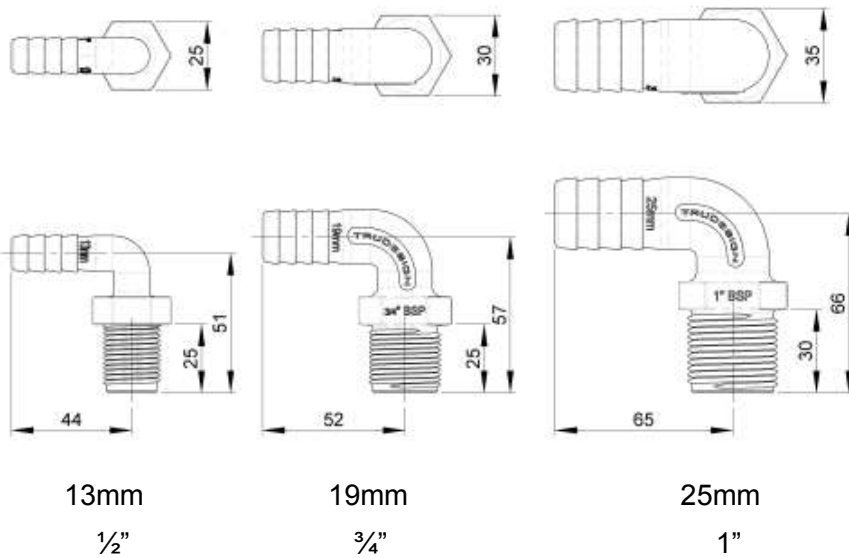

LEADERS IN MARINE COMPOSITE FITTINGS

www.trudesignplastics.com



GENERAL
Marine
SERVICES

156 Beaumont Street · Westhaven · Auckland · New Zealand

Sales Ph +64 9 309 0048 · sales@generalmarine.co.nz

Service Ph +64 9 368 0938 · service@generalmarine.co.nz

www.generalmarine.co.nz



PRODUCT INFORMATION

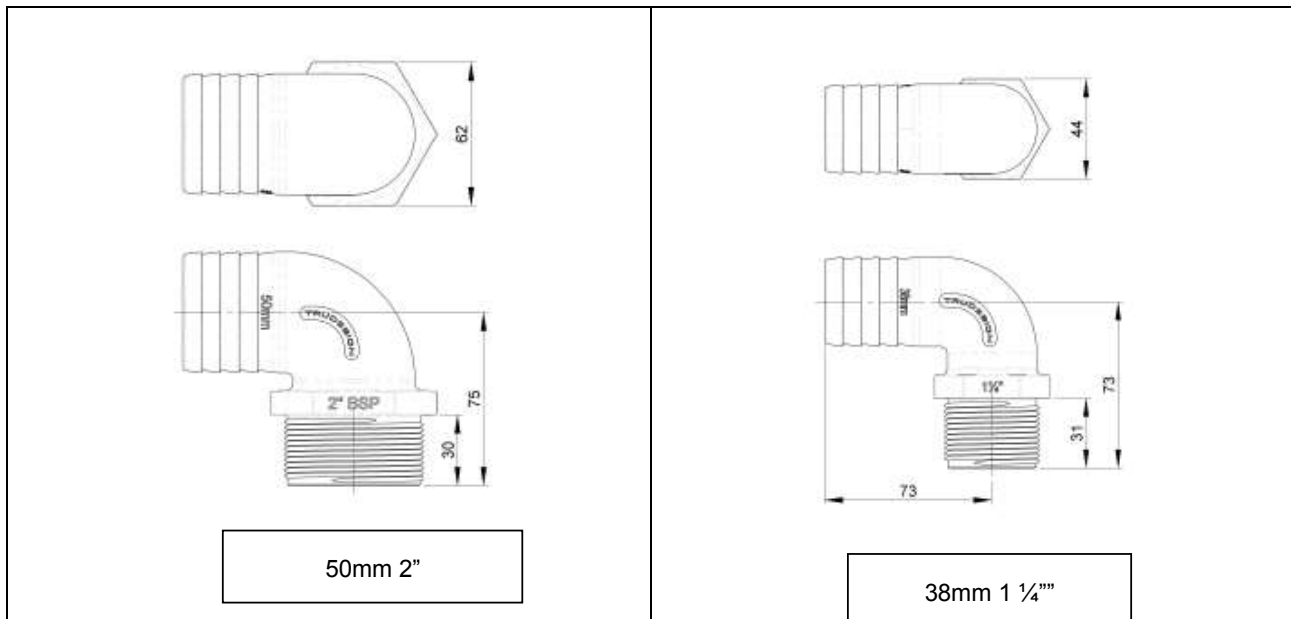

INSTALLATION

- 1.) Ensure the fitting that the Tail is attaching into has a clean and undamaged thread.
- 2.) Apply a small amount of a suitable marine grade adhesive sealant such as SIKAFLEX® 291i or 3M™ Fast Cure 5200 to the thread (see manufacturer's notes), or, wind several turns of PTFE thread sealing tape onto the thread (clockwise when viewed from the bottom of the thread).
- 3.) Wind the Tail into the other fitting being mindful not to cross-thread the two. Lightly tighten the Tail by hand crescent or open-ended spanner. Note: When adhesive type thread sealant is used, fittings do not need to be fully tightened as the sealant will provide full waterproofness once cured. This allows orientation of the Tail anywhere across a full 360° - which can help to obtain tidy routing and positioning of hoses.
- 4.) Fit the hose after the adhesive sealant has cured by using hot water to soften.
- 5.) Apply twin hose clamps for a secure connection.

SERVICING

Tails should be checked for secure fitting into other fittings at regular intervals. Check Hose Clamps are tight.

The information contained in this information sheet is for general information purposes only. The information is provided by TruDesign and while we endeavour to keep the information up to date and correct, we make no representations or warranties of any kind, express or implied, about the completeness, accuracy, reliability, suitability or availability. Any reliance you place on such information is therefore strictly at your own risk.

LEADERS IN MARINE COMPOSITE FITTINGS

www.trudesignplastics.com



GENERAL
Marine
SERVICES

156 Beaumont Street · Westhaven · Auckland · New Zealand

Sales Ph +64 9 309 0048 · sales@generalmarine.co.nz

Service Ph +64 9 368 0938 · service@generalmarine.co.nz

www.generalmarine.co.nz